

CONL

COLLECTIECENTRUM NEDERLAND

**A shared storage facility
in the heart of The Netherlands**



Rijksdienst voor het Cultureel Erfgoed
Ministerie van Onderwijs, Cultuur en
Wetenschap

RIJKS MUSEUM



PALEIS HET LOO

HEDERLANDS
**OPENLUCHT
MUSEUM**

CONL

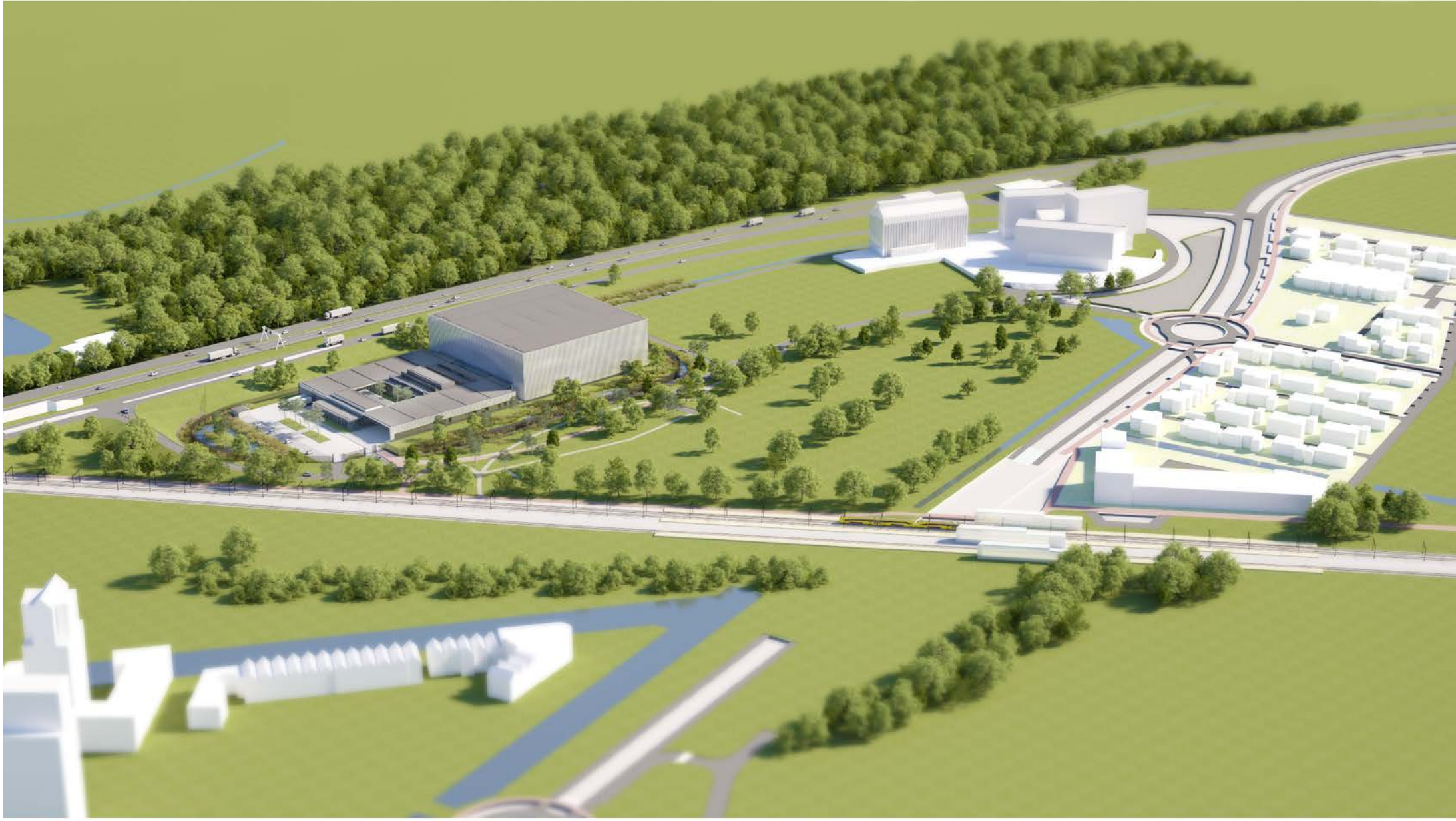

CONL

PROJECT HISTORY 

CONT

The art of Collaboration

Introduction Karen

Thesis MBA 2010

IDEA (initiated in 2011)

A new, shared storage facility

- sustainable and carbon neutral
- environmental conditions according to the latest scientific research
- cooperation between 4 heritage institutions
- centrally located within The Netherlands
- a study and research centre to promote the use of the collections



CONL

WHY?

Current storage facilities are outdated

Shifts in government policy

- budget cuts for museums
- focus on cooperation between museums and heritage institutions

Shifts in attitude towards the environment

- global warming
- focus on renewable energy

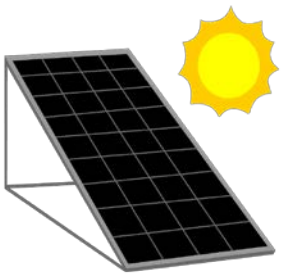

CONL

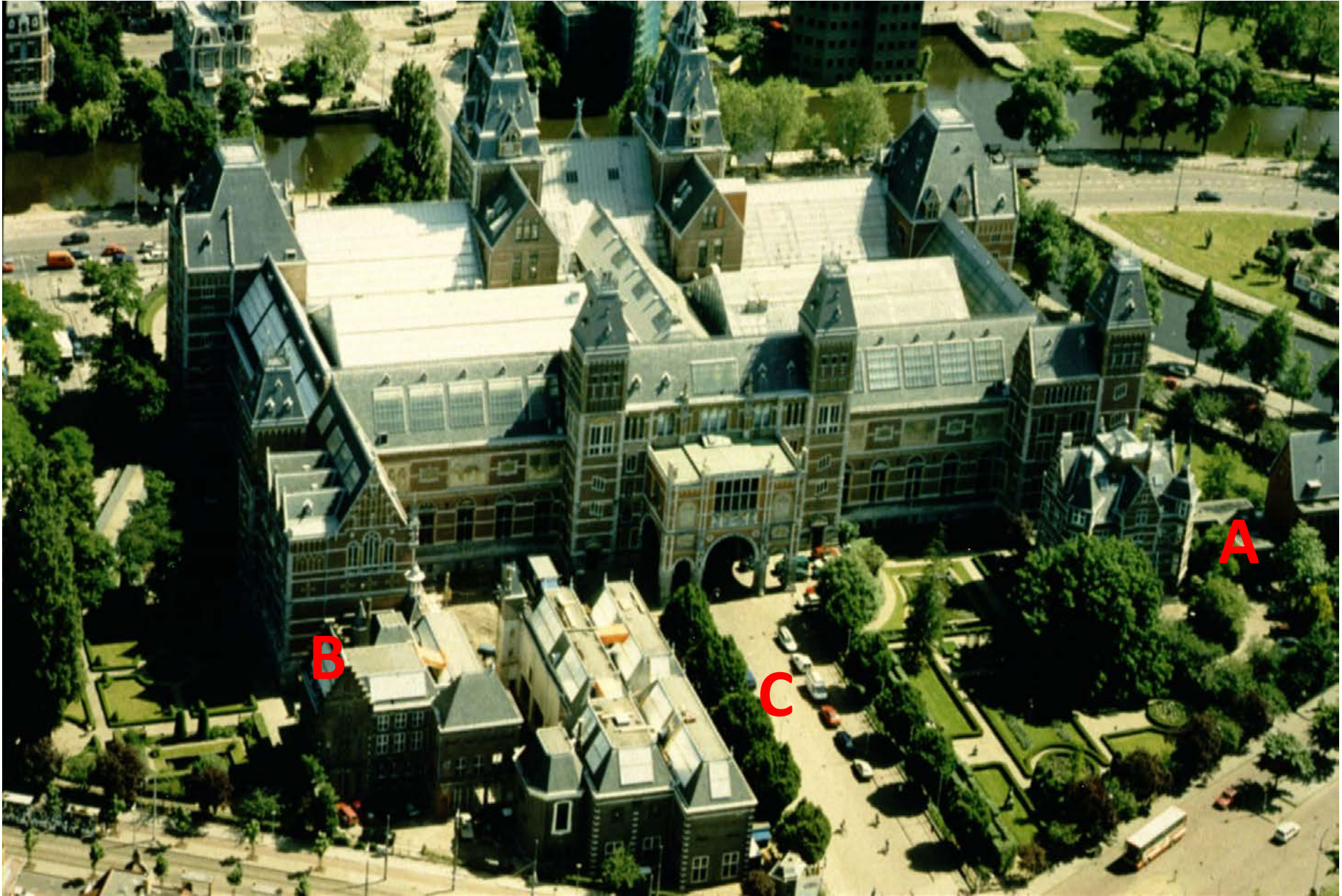

CONL

PARTICIPATING INSTITUTIONS



 Rijksdienst voor het Cultureel Erfgoed
Ministerie van Onderwijs, Cultuur en
Wetenschap



 PALEIS HET LOO



 NEDERLANDS
OPENLUCHT
MUSEUM



RIJKS MUSEUM

CCNL

OPEN AIR MUSEUM



HET LOO PALACE



APPROXIMATELY 675.000 OBJECTS DESTINED FOR CC NL...



RIJKSMUSEUM

CULTURAL HERITAGE AGENCY (RCE)

CONL

CHOICES & PRINCIPLES
COLLECTION MANAGEMENT

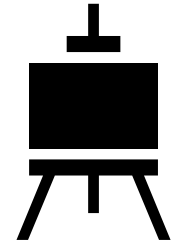

CONL

OPTIMAL STORAGE CONDITIONS & SUSTAINABILITY

zone	T specs	RV specs (max. 1% fluctuation per 24 hours)
A – Denmark	Outside temperature	50±8
B	$T \geq 12^{\circ}\text{C}$	50±8
C	$17 \leq T \leq 23^{\circ}\text{C}$ (max. 1 degree fluctuation per 24 hours)	50±8
D	$17 \leq T \leq 23^{\circ}\text{C}$ (max. 1 degree fluctuation per 24 hours)	45±8
Cold storage	$T < 6^{\circ}\text{C}$	45±8

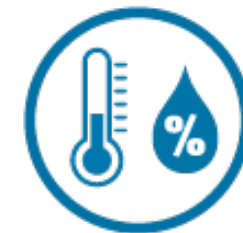

CONL

STORAGE AREAS

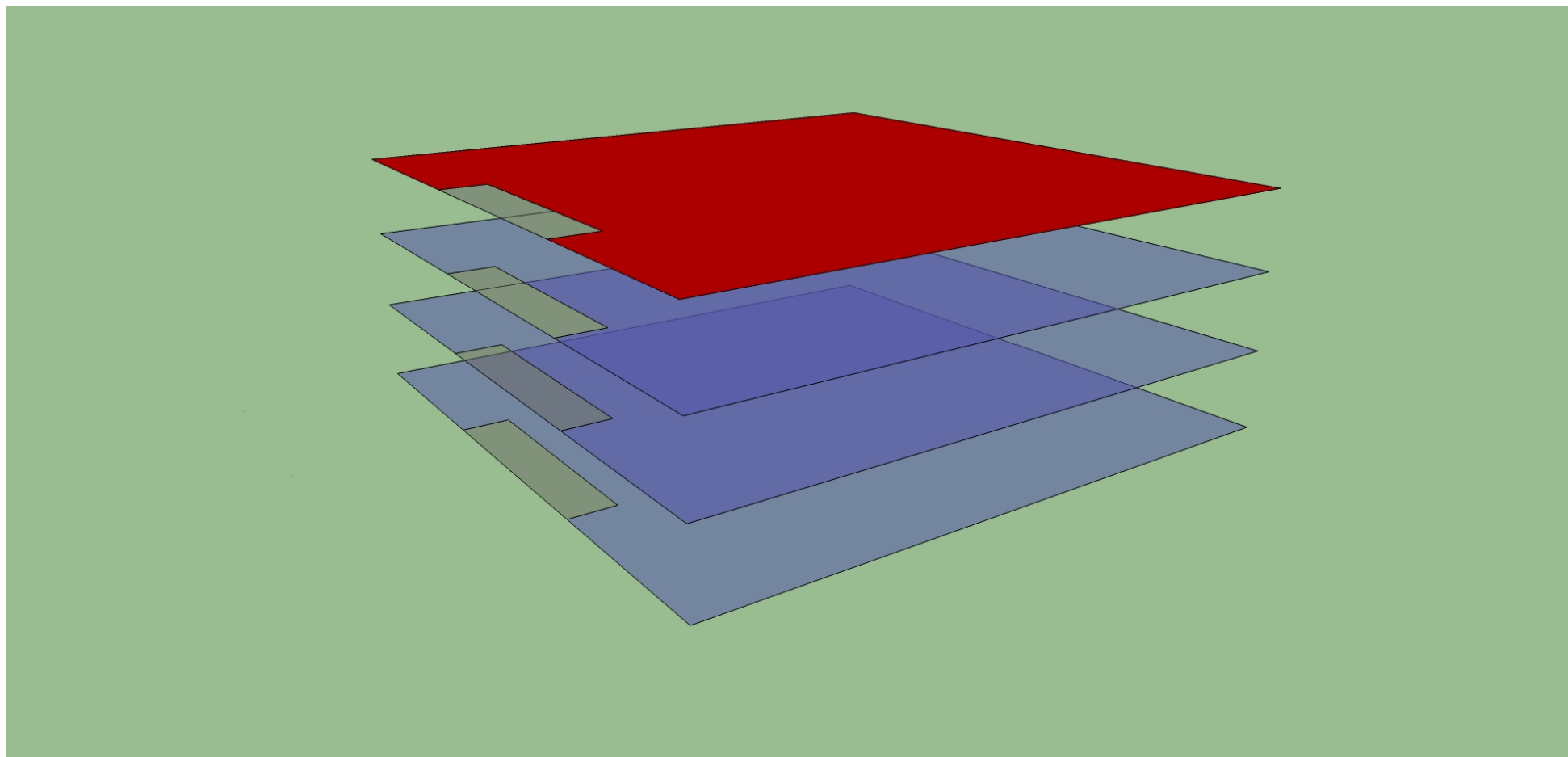

CONL

STORAGE AREAS

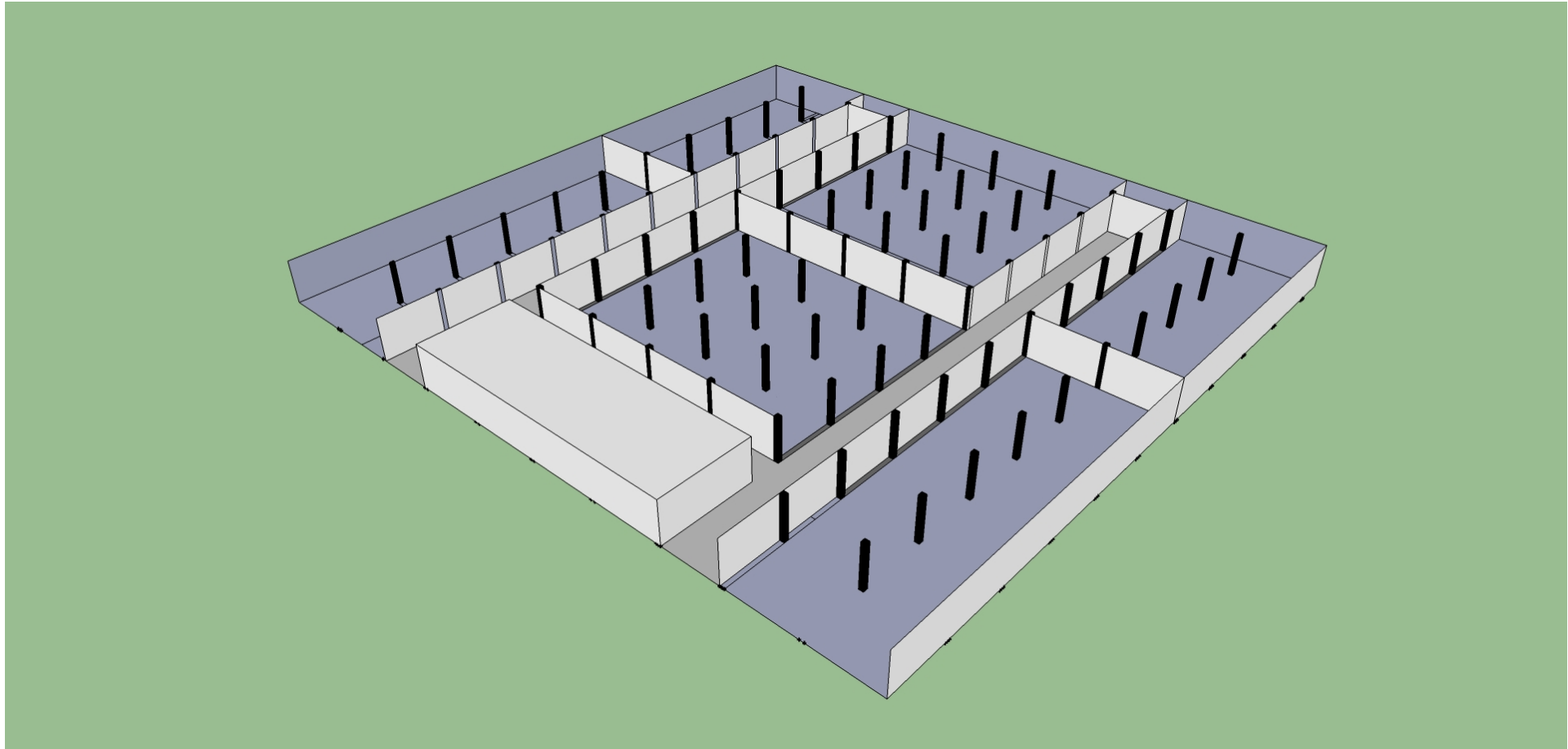

CONL

STORAGE AREAS

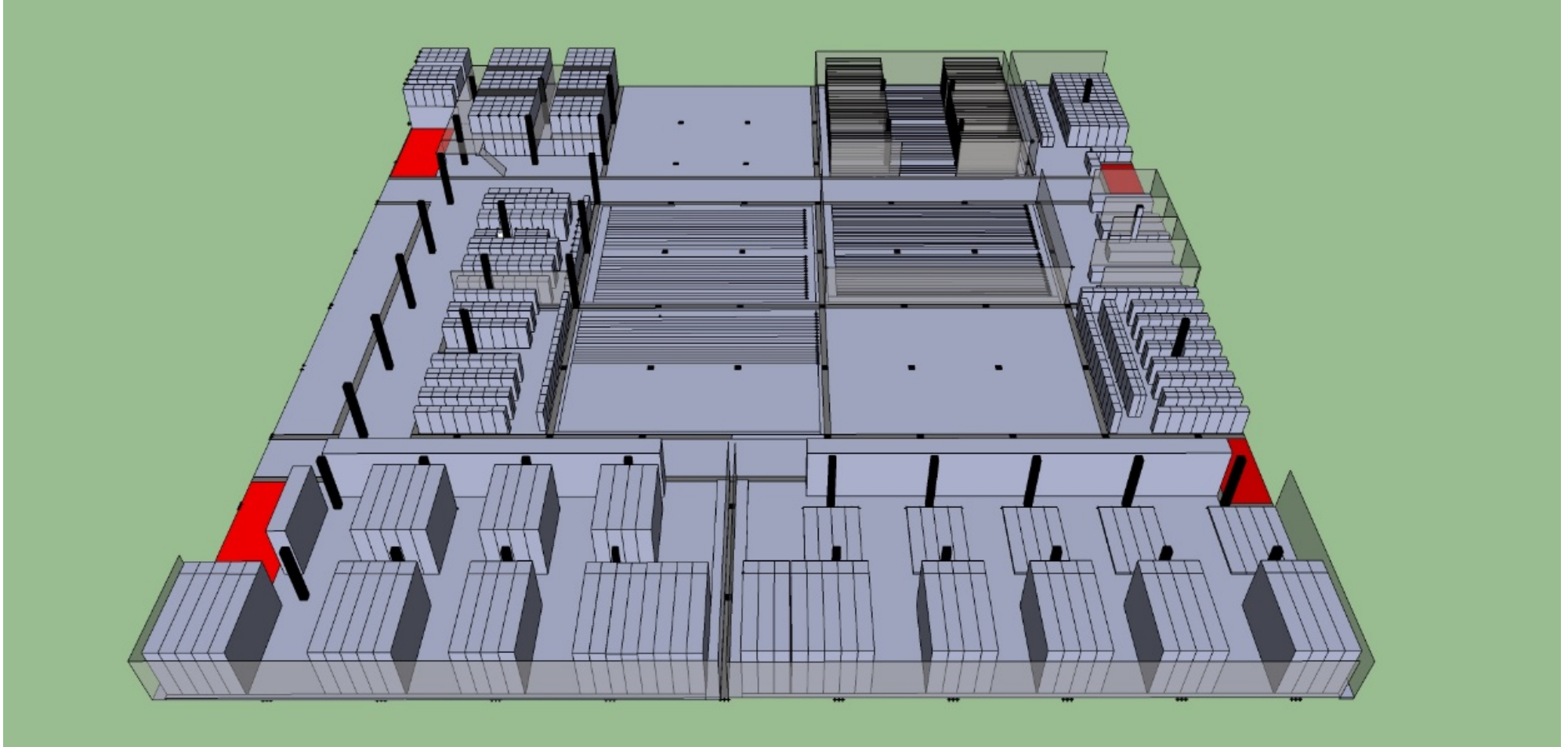

CONL

STORAGE AREAS

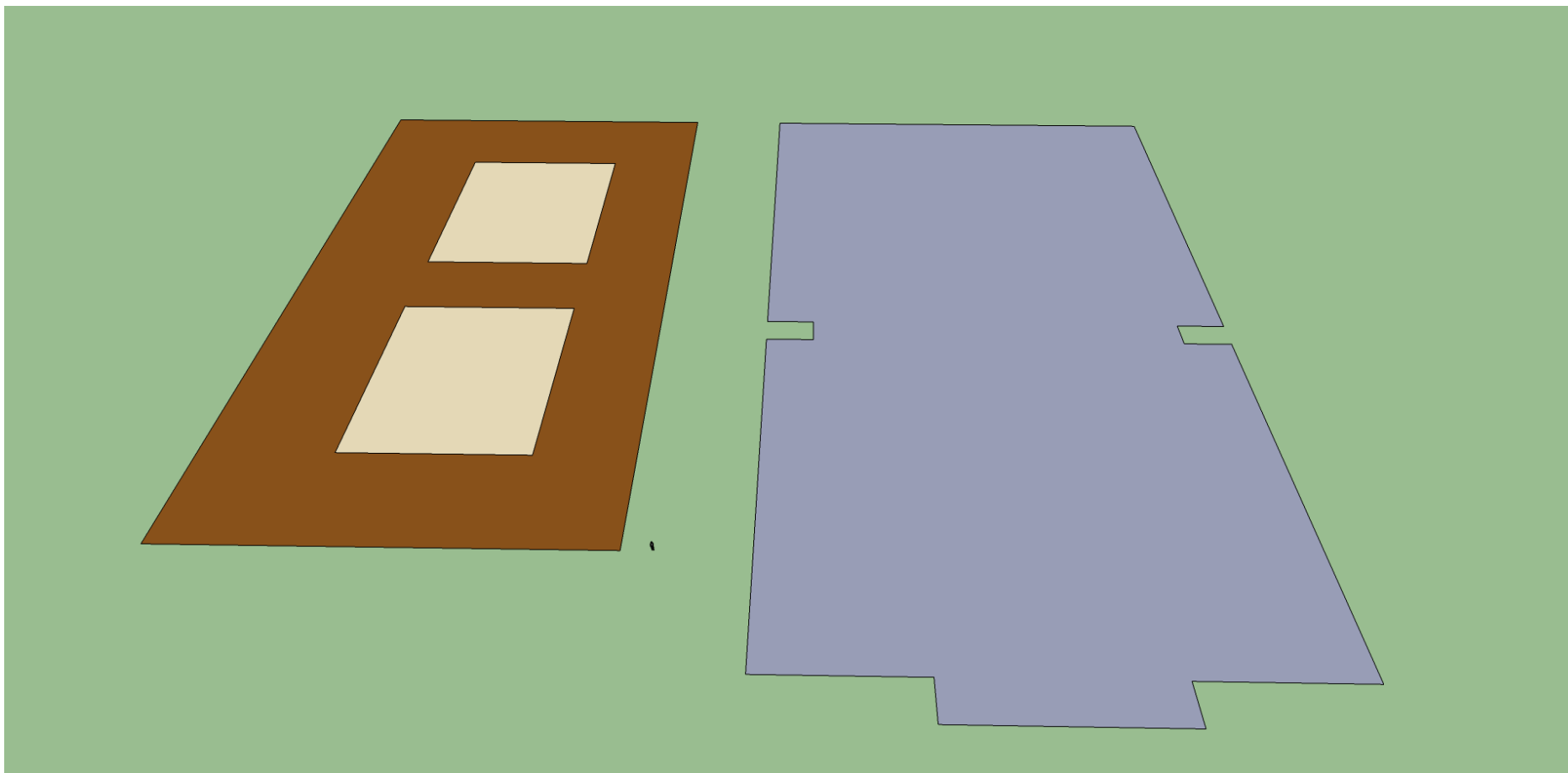

CONL

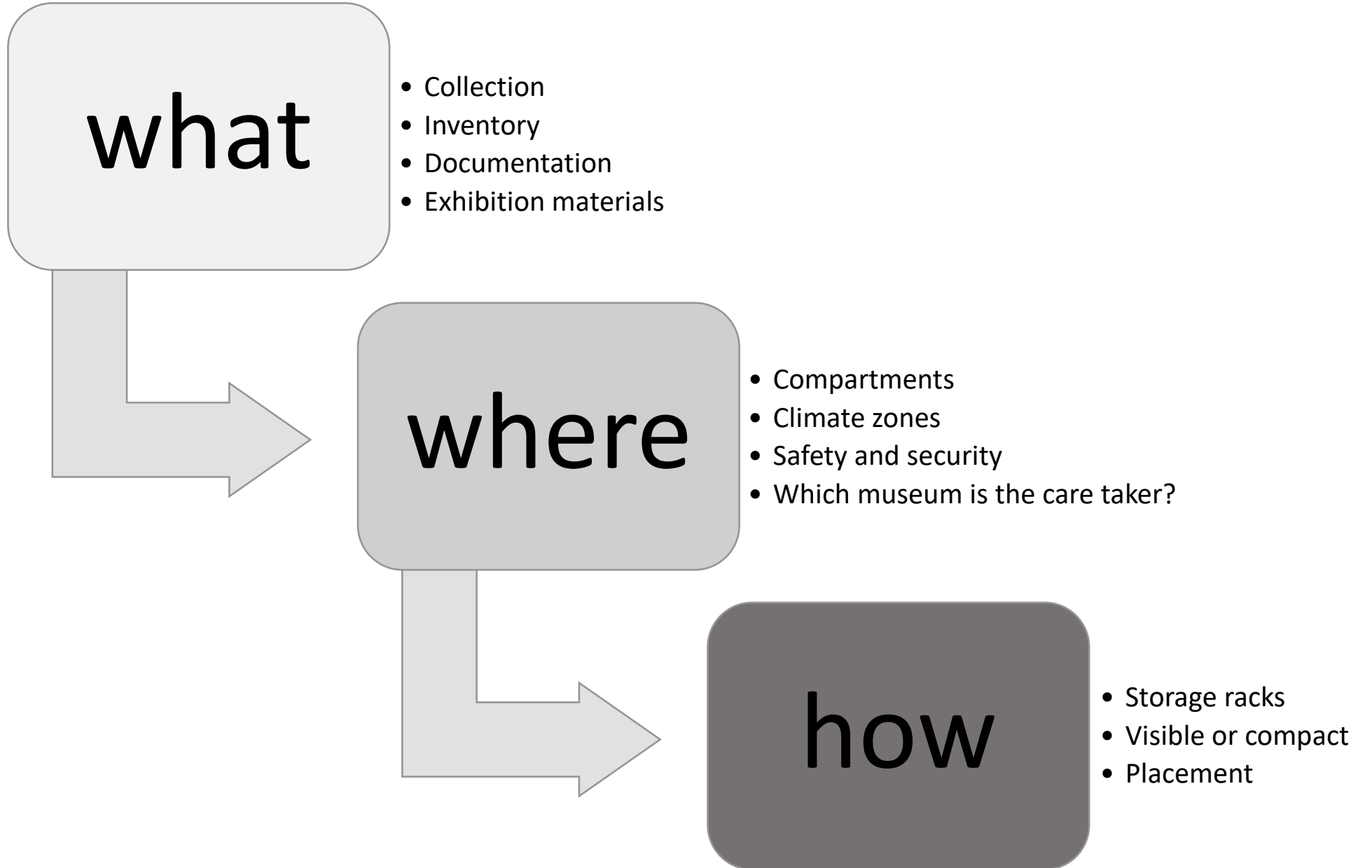

STORAGE AREAS: ACCESSIBLE WHERE POSSIBLE, COMPACT WHERE NECESSARY

CONL



CONL

STORAGE AREAS: COMPACT STORAGE



CONL

STORAGE AREAS: A COMBINATION OF COLLECTIONS RATHER THAN A MIXTURE



CONL



CONL

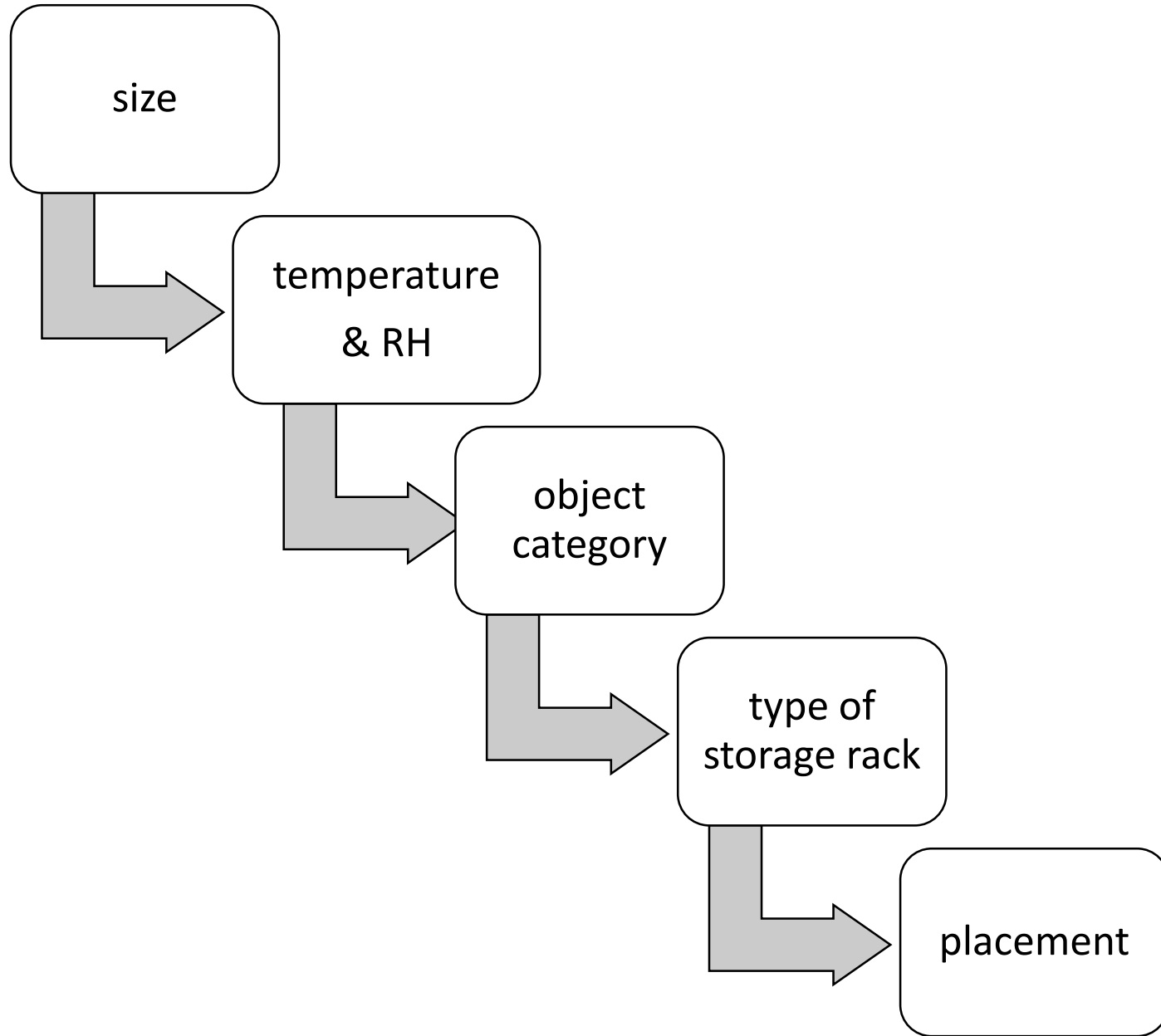

CONL



Afbeelding basis + zambouzwak



CONL



CONL

**THE BUILDING
DESIGN PRINCIPLES**



PROJECT TIMELINE: PROJECT SCOPE

- 2011 – 2013: Development Project Scope
- 2014: Programme of Requirements and Building Brief (Client RCE)
- January 2015 – June 2015: Development Business Case (integral feasibility study)
- July 2015 – Business Case approved by Ministry

Partnership formalised, with Rijksmuseum as ‘contractor’ and owner

PROJECT TIMELINE: DESIGN PROCESS



- July 2016: Procurement Strategy Design Team
- August 2016 – April 2016: Selection of Design Team
- April 2016 – July 2016: Preliminary Design
- July 2016 – April 2017: Final Design
- April 2017 – September 2017: Performance Design
- September 2017: Approval Planning Commission

CONL



CONL

LAYOUT: HEAD – NECK – BODY MODEL

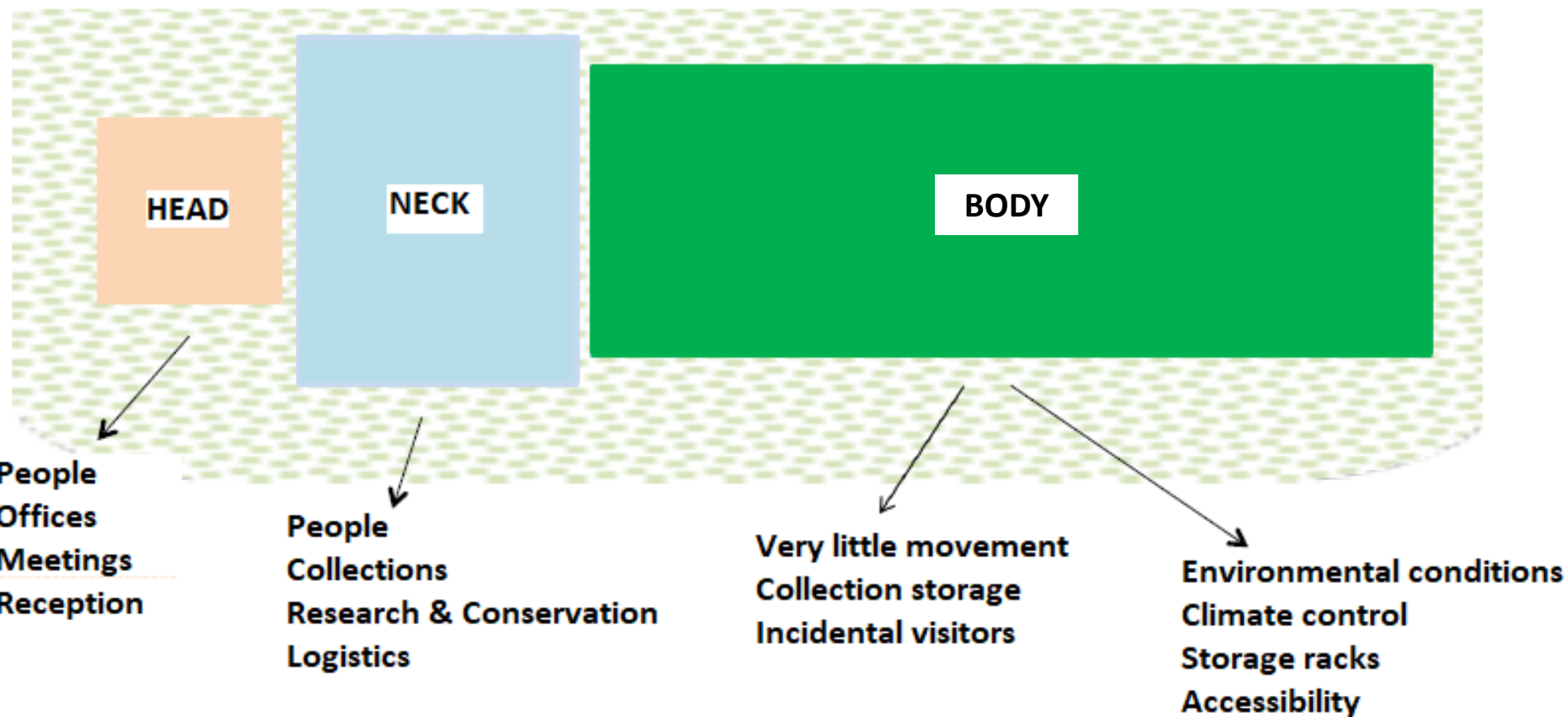

FACILITIES



31.000 m² total floor space
162 m x 63 m x 24,3 m =
about 6 football pitches



25.000 m² storage area



5.000 m² conservation & research



1.250 m² offices and facilities



FACILITIES

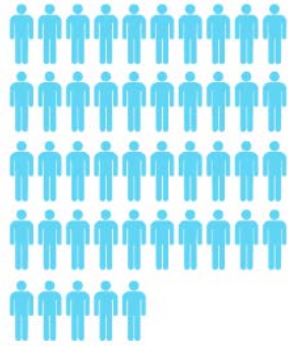

offices and
workspace
for 45 people



facilities for up
to 30 visitors
at a time



23 parking
spaces
+ 2 disabled

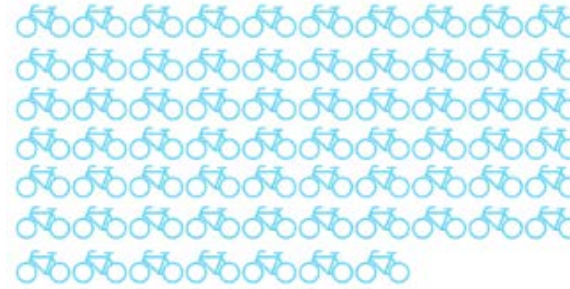

47 parking spaces
for bicycles



space for
3 trucks

CONL

SUSTAINABILITY

- BREEAM-NL level outstanding (5 stars)
- more than 2.000 solar panels on the roof
- (almost) carbon neutral
- energy efficient building
- innovative climate control concept



PROJECT TIMELINE: LOCATION

- 2012 – 2015: Longlist of locations
- 2015 – Shortlist of locations tested based on PoR: Amersfoort Vathorst (Podium) selected
- 2015 – 2017 Negotiations with Municipality of Amersfoort
- May 2016 – Letter of Intent
- December 2017 – Purchase Agreement
- May 2018 – Transfer of Land

LOCATION: AMERSFOORT

- above sea level (+3 meters average)
- central location
- large plot of land available
- next to a train station
- next to a main road



CONL

LOCATION: AMERSFOORT



PROJECT TIMELINE: CONSTRUCTION

- July 2017: Procurement Strategy Contractors
- September 2017 – February 2018: Selection of Contractors
- May 2018: Start Construction Phase
- October 2018: Piling completed (last week)
- October 2018: Contracting of Security Provisions
- February 2019: Start of Fine Finishing (until January 2020)
- April 2020 – Transfer of Building

CONT

THE BIG MOVE 

PREPARING THE COLLECTIONS FOR RELOCATION

CCNL



Relocating 675.000 objects...



...including very large and technically challenging ones...



...from 10 different locations to CC NL



PRINCIPAL REQUIREMENTS

- Correct storage packaging and supports (trays, boxes, frames))
- Condition checks and conservation where necessary
- Cleaning and pest management
- Registration check
- Instructions for handling
- Marking of objects containing hazardous substances
- Photography - at least one image of every object for identification purposes
- Barcode labels



CONL

PACKAGING & SUPPORTS FOR SAFE TRANSIT & STORAGE



Acid-free boxes
for prints and other
works on paper



Mobile and easy
to transport frames
for chandeliers

CONDITION CHECKS, CLEANING & CONSERVATION

- Fixing flaking paint, consolidating loose fragments
- Mounting & framing
- Cleaning
- Pest management
- Identifying & labeling objects made of or containing hazardous substances (uranium, asbestos)



REGISTRATION | PHOTOGRAPHY | BARCODES

- Object number & name/title
- Measurements
- Photograph
- Name of the curating museum
- Description
- Location
- Barcode label: affixed to the object, the packaging and the location



SHARING COLLECTIONS MANAGEMENT SOFTWARE

Wish: a shared, online system to manage object locations in CC NL

Challenge: 3 partners currently use Adlib (Axiell), 1 uses TMS (Cit)



CCNL

Collection Management

SOLUTION

Locations & Logistics Management

Partners' own tools (Adlib & TMS)

- Management of one's own collection
 - Registration
 - Conservation
- Loans (in & out)
 - Contracts & legal
 - Administration & finance
- Orders from CC NL:
 - Transport of objects
 - Acquisitions
 - Internal relocations

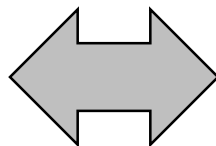

CC NL Location Management System (LMS)

- Logistic operations for CC NL partners:
 - Preparing & planning transport of objects
 - Internal relocations
- Feedback to partners:
 - Information about object relocations & transportations
 - Information about damage to objects, missing objects etc.



RIJKS MUSEUM



+ CCNL

CC NL LOCATION MANAGEMENT SYSTEM (LMS)

- Partners' own tools (Adlib & TMS) feed initial data about the objects into CC NL LMS
- Constant syncing between Adlib, TMS and LMS
- LMS keeps Adlib & TMS up-to-date about object locations
- LMS is the main digital tool used for the initial relocation of all the objects to CC NL using barcodes for tracking & tracing



CONL

PLANNING

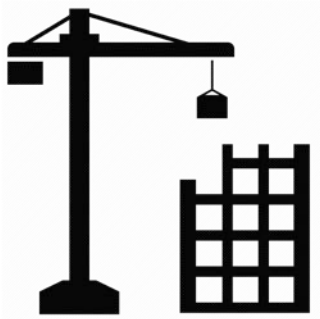

**construction
2018 – 2020**



**fitting & assembling
storage furniture – 2020**

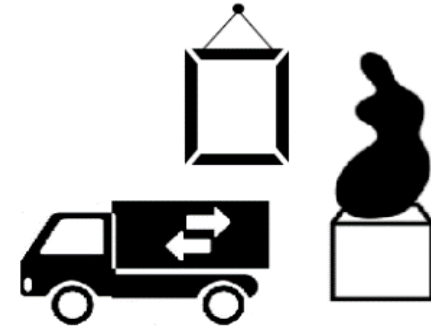

**relocation
2020 – 2021**

CCNL



www.collectiecentrumnederland.nl